

Name _____ Date _____

A company in Australia builds and delivers cube-shaped room modules that can be put together to make a house. In the plan below, there are two bedrooms, a kitchen, and a living room composed of two cubes. The edge of each cube is 7 meters long.

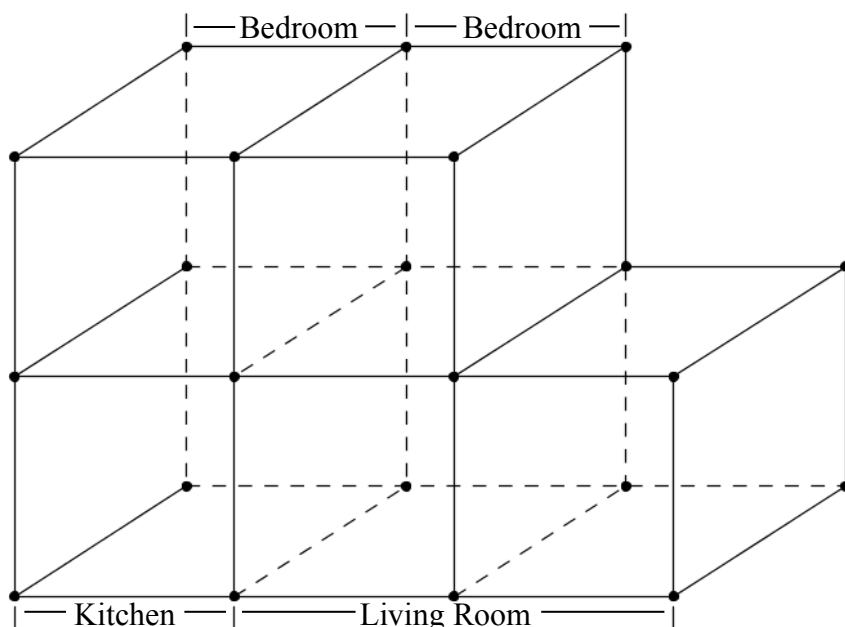

1. Write an expression, using exponents, that represents the total volume of the house.
2. Write an expression, using exponents, that represents the combined areas of the floors of the house.

Name _____ Date _____

Write in expanded form and calculate.

1. 2^4

2. $\left(\frac{2}{5}\right)^3$

3. 0.8^2

Name _____ Date _____



Paul's dad gives him two pennies on the first day of the month. On the second day, he gives him four pennies, and on the third day, he gives him eight pennies. Suppose Paul's dad continues giving him pennies in this way.

Day	Number of Pennies
1	2
2	4
3	8



Write and evaluate a numerical expression using exponents to determine how many pennies Paul receives on the eighth day.